

CODE NUMBER

11070003

DESCRIPTION

Vitreous China Washdown Urinal.

DETAILS

- Flush volume determined by the flushometer used with the fixture
- Nominal Dimensions: 12.60" x 14.96" x 25.00" (320 x 380 x 635mm)

FEATURES

- Designed to maximize and complement Sloan flushometers
- Small size and clean lines fits a large variety of applications and restroom looks
- Thorough washdown flushing action
- Durable, hygienic vitreous china construction
- Vandal resistant stainless steel strainer included

PLUMBING SYSTEM REQUIREMENTS

- Minimum Flowing Pressure: 25 PSI (172 kPa)
- Maximum Static Pressure: 80 PSI (552 kPa)

DOWNLOADS

- [SU-7025 Installation Instructions - India](#)
- [SU-7025 Repair & Maintenance Guide](#)
- [Fixture Full Line Brochure \(India\)](#)



NOTES

All information contained within this document subject to change without notice.

All vitreous china dimensions shown in these drawings are nominal and not to scale.

[Find a compatible flushometer](#) for this urinal.

ROUGH-IN

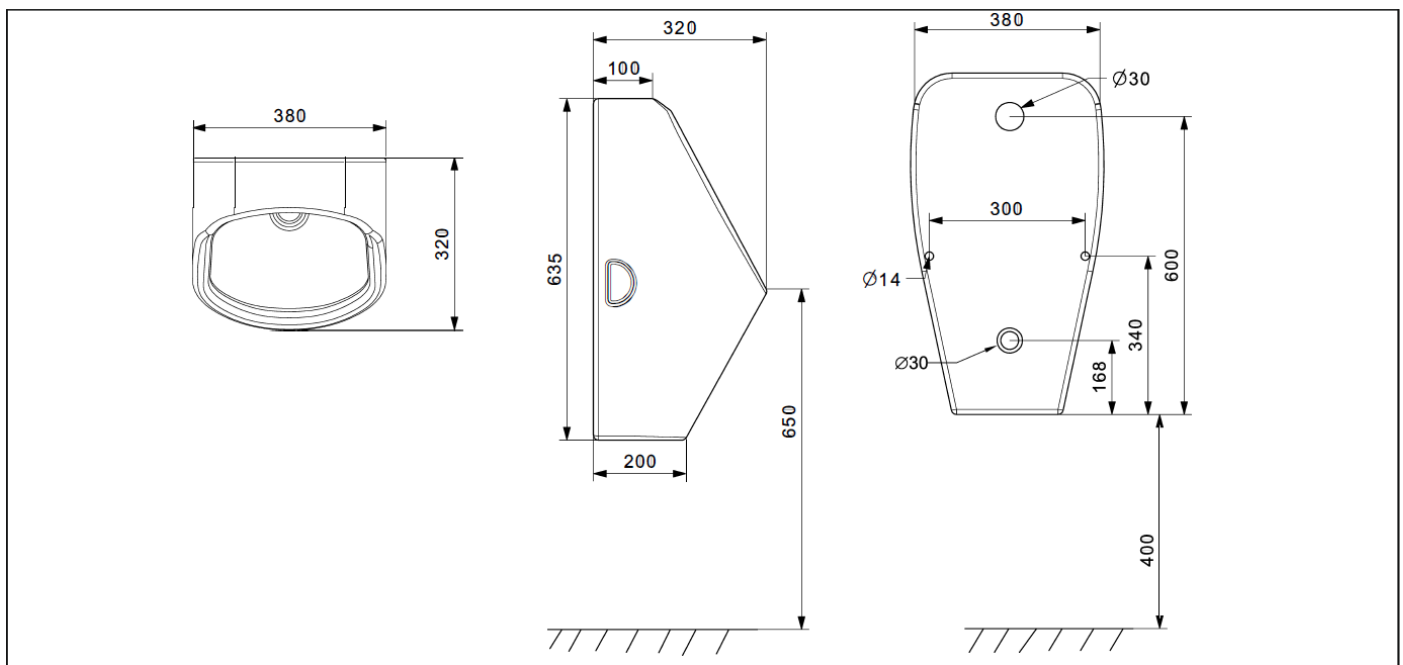

Sloan India 344, Udyog Vihar Phase II, Gurugram 122015, Haryana, India

Toll Free: 1.800.123.3080 | sloan.in